

Single Leg Landing Gear
Kit#21300



Note: The brackets supplied with this system were designed for single leg landing gear legs. The legs can be found on conventional or “fifth wheel” trailers. You can refer to figure 4 on page 2 for an overview of how the brackets will be mounted.

1. Remove the crank handle from the landing gear leg.
2. Locate the motor and face plate.
3. Bolt the motor to the face plate.
4. Slide the motor and face plate over the landing gear output shaft. Refer to figure 1 below.

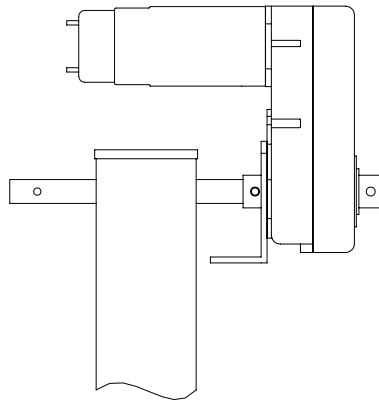

Figure 1.

5. Line up the hole in the motor shaft with the hole in the landing gear shaft and insert the roll pin.
6. Locate the steel side plate. Refer to figure 2 below.

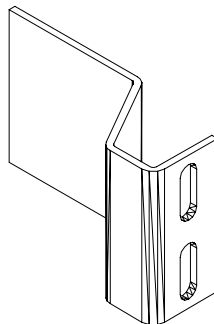

Figure 2.

7. Loosely bolt the face plate to the side plate, using the 5/8” bolts supplied. Refer to figure 3 below.

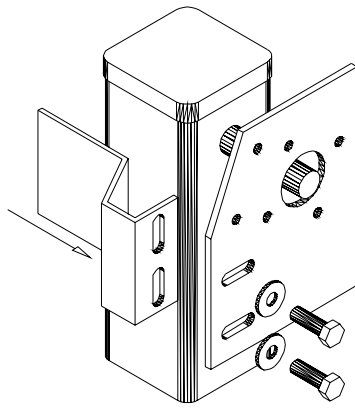

Figure 3.
Shown without
the motor

8. Adjust the face plate and side plate so they are square with one another. Refer to figure 4.

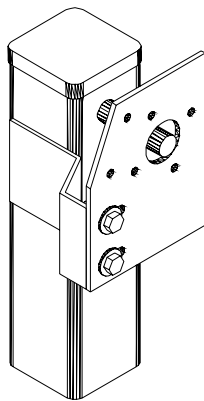

Figure 4.
Shown without
the motor

9. Once the motor is in line with the landing gear shaft, and the brackets are square with one another, weld or bolt the side plate to the landing gear leg.

Wiring the System

1. Refer to the wiring diagram included with the wiring kit.

Revision 3 4/11/05
