



Automated Covering Systems



# Semi-Automatic, Light Truck

Semi-Automatic, Manual Tarp System for Light Truck

**Part Number: 62XX**

## 62xx Semi-Automatic, Tarp System for Light Trucks w/Tarp Wound Under the Axle (specify width)

62XX Semi-Automatic, Tarp System for Light Trucks w/Tarp Wound Under the Axle (specify width)

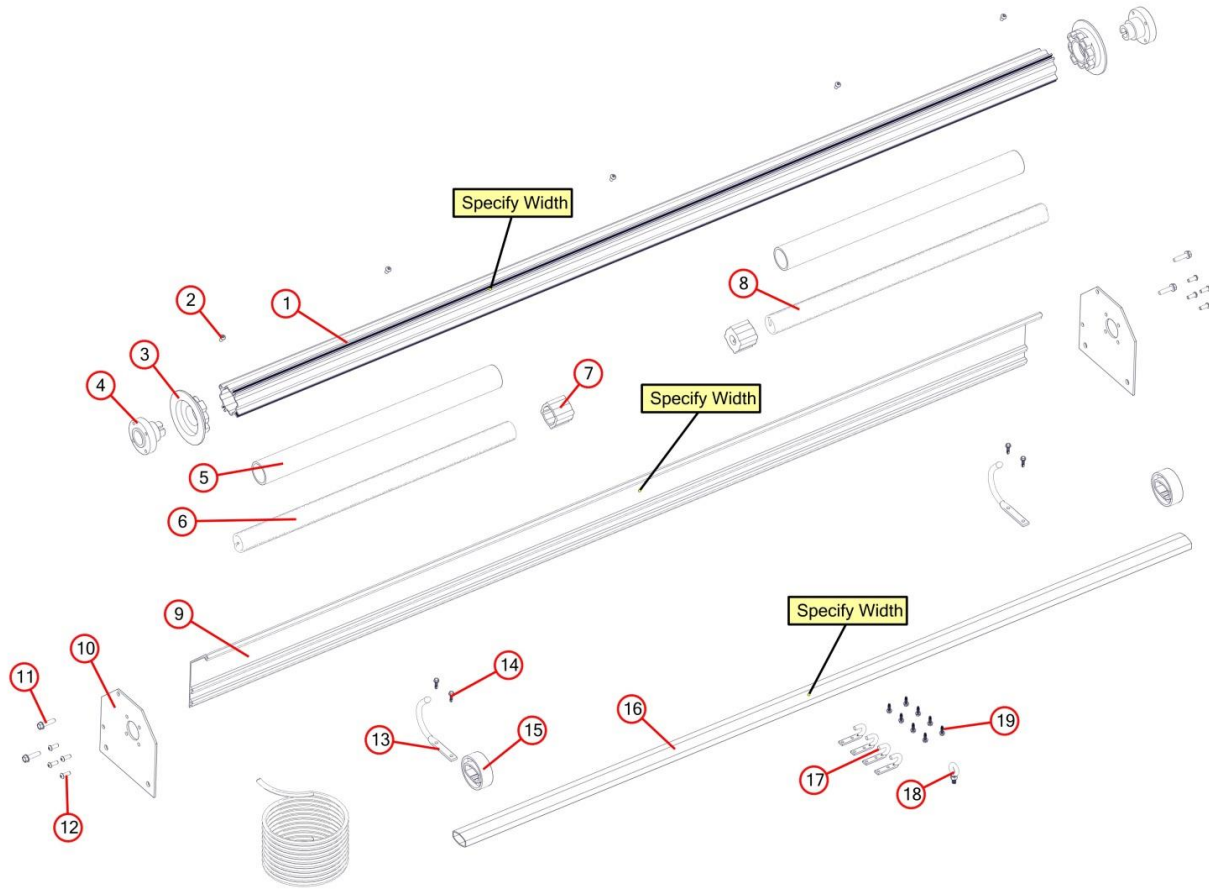

Bom ID	Part#	Description	Qty
Ref	62xx	Semi-Automatic, Tarp System for Light Trucks w/Tarp Wound Under the Axle (specify width)	1
1	62040	Tarp Axle for Semi Automatic -Specify Length-	1
2	18260	Bolt, 5/16" x 5/8" Button Head Bolt-Zinc Plated	5
3	62010	Bushing, End Bushing for Semi Automatic External	2
4	62000	Hub, for Semi-Auto System	2
5	62090	Sleeve, Spring Sleeve-Semi -2" pvc-	2
6	62130	Spring, for Semi Automatic System -Driver Side, ea-	1
7	62020	Slide, Spring Slide for SA System Adapter Internal	2
8	62030	Spring, for Semi Automatic System -pass, each-	1
9	36500	Wind Deflector, Custom for Semi Automatic System - Specify Length	1
10	62100	Bracket, Aluminum Semi Auto Tarp Brackets-Pair	2
11	18120	Bolt, 3/8" x 1-1/2" Thread Cutting Screw Hex Washer Hd	4
12	18210	Bolt, 5/16" x 7/8" Button Head	8
13	62060	Hook, Large Tarp Bar	2
14	18110	Bolt, 1/4" x 1" Self Drilling Hex Washer Head	4
15	76810	Flange, Tarp Flange -pair-	1
16	62080	Extrusion, Tarp Bar - Aluminum Bow Tube	1
17	62050	Hook, Small Rope	4
18	18236	Bolt, 3/8-16 x 1" Eye bolt Zinc W/Nut	1
19	18100	Bolt, 1/4 - 20 x 3/4" Type F Self Tapping	8