

# Bow Sets

Bow, Arm



**RollRite.com**

**Automated Covering Systems**

650 Industrial Drive • Gladwin, MI 48624

## Welcome to Roll-Rite® Automated Covering Systems

Roll-Rite® designs and manufactures state-of-the-art, automated tarp systems for the global heavy duty trucking industry serving the Construction, Agriculture, Waste and Recycling markets. Our systems quickly and reliably contain and protect payloads, create a safer working environment for drivers, and maximize our customer's return-on-investment by increasing revenues and reducing cost of ownership.



### Customer Service:

**800-297-9905** US & Canada

**989-345-3434** International

**989-246-1035** Fax

### Physical Address:

650 Industrial Drive

Gladwin, MI 48624

[www.RollRite.com](http://www.RollRite.com)

Contents

76700 Bow Set, 98" Wide Top Tube w/ 98" Side Arms ..... 1  
76720 Pivot Set, 4 Spring w/ 60" Aluminum Pivot Tube .....2  
Appendix B:Parts Index ..... B

**76700 Bow Set, 98" Wide Top Tube w/ 98" Side Arms**

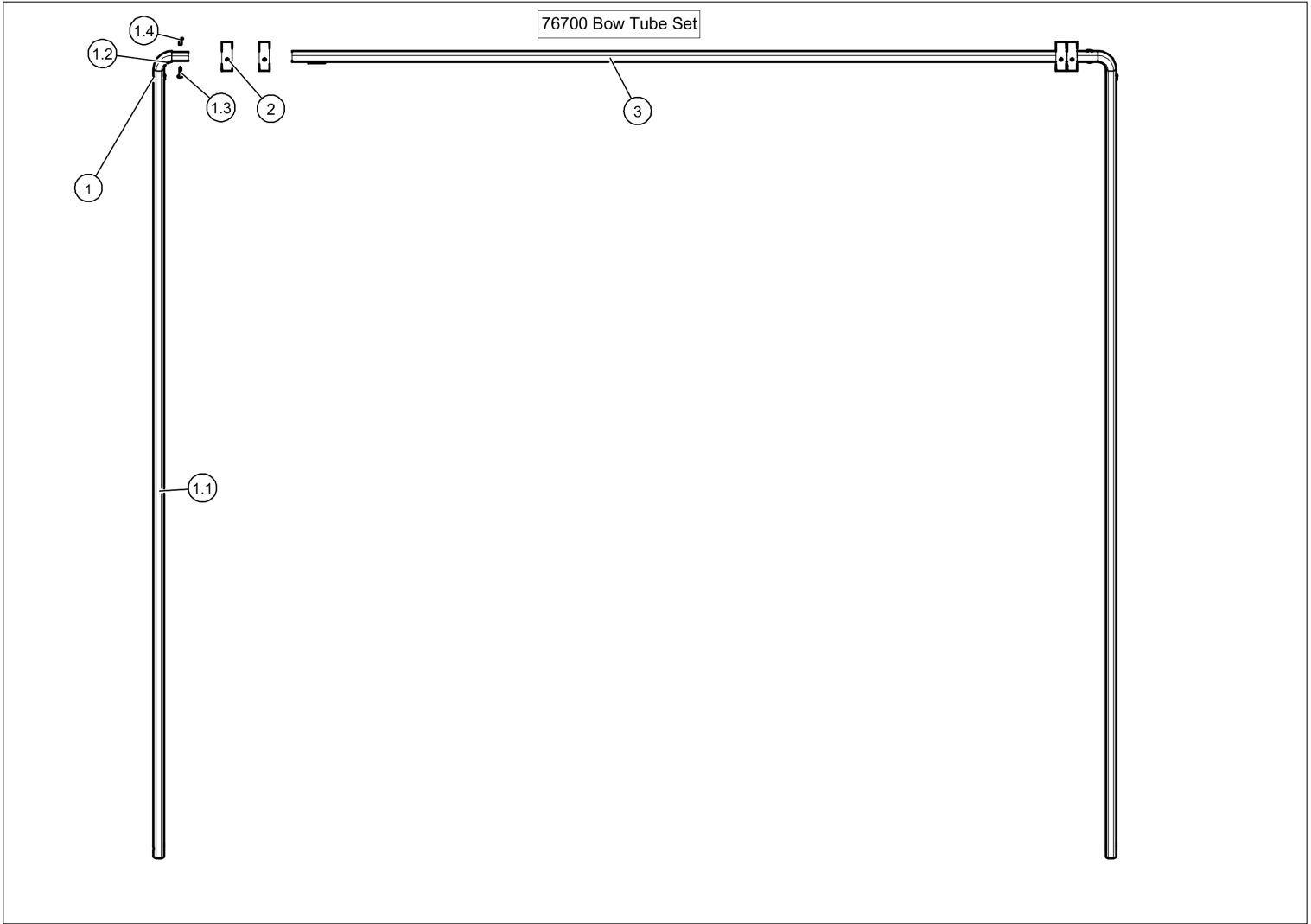

Item	Part No.	Name	Qty
Ref	76700	Bow Set, 98" Wide Top Tube w/ 98" Side Arms	1
1	76760	Bow Tube, 98" Al Side Arm W. 90° Corner	2
1.1	76770	Bow Tube, AL Top Tube for Tarp Bow 98"	1
1.2	76800	Casting, Aluminum Corner - 90 Degree	1
1.3	18718	Bolt, 1/4-20 x 1 3/16 Golt Clear Zinc - Post bolt for 90 degree corners	2
1.4	18719	Nut, 1/4-20 Cap Conn Nut Clear Zinc - Post bolt for 90 degree corners	2
2	76810	Flange, Tarp Flange -pair-	2
3	76770	Bow Tube, AL Top Tube for Tarp Bow 98"	1

**76720 Pivot Set, 4 Spring w/ 60" Aluminum Pivot Tube**

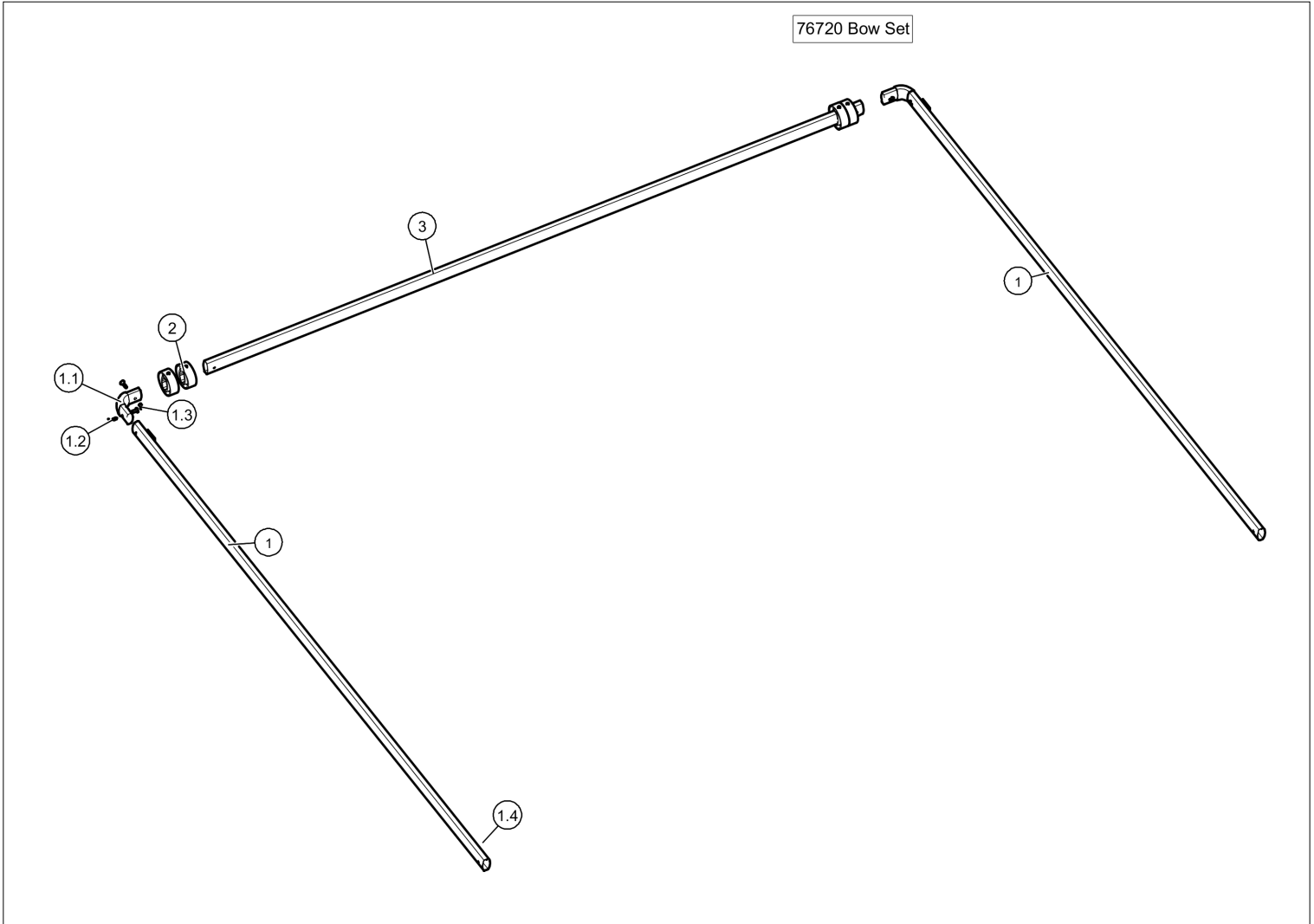

Item	Part No.	Name	Qty
REF	76720	Bow Set, 103 1/2" Wide Top Tube w/ 98" Bow Arms	1
1	76760	Bow Tube, 98" Al Side Arm W. 90° Corner	2
1.1	76800	Casting, Aluminum Corner - 90 Degree	2
1.2	18718	Bolt, 1/4-20 x 1 3/16 Golt Clear Zinc - Post bolt for 90 degree corners	2
1.3	18719	Nut, 1/4-20 Cap Conn Nut Clear Zinc - Post bolt for 90 degree corners	4
1.4	76770	Bow Tube, AL Top Tube for Tarp Bow 98"	4
2	76810	Flange, Tarp Flange -pair-	2
3	76870	Bow Tube, AL Wide Top Tube for Tarp Bow - 103 1/2"	1

## Appendix B:Parts Index

18718	.....	1, 2
18719	.....	1, 2
76700	.....	1
76720	.....	2
76760	.....	1, 2
76770	.....	1, 1, 2
76800	.....	1, 2
76810	.....	1, 2
76870	.....	2



**Automated Covering Systems**

650 Industrial Drive · Gladwin, MI 48624

### **Warranty Policy**

Roll Rite, LLC warrants all of its products except tarps to be free of defects in material or workmanship under normal use and service for a period of one year from date of shipment.

In addition, Roll Rite, LLC warrants all of its electric and hydraulic gear motors against premature wear out. Gear motors using worm gears are warranted against wear out for a period of three (3) years. Gear motors using spur and/or helical gears are warranted against wear out for a period of five (5) years.

Roll-Rite, LLC shall be the sole judge of the warrantability of alleged product defects or premature wear. Roll-Rite, LLC reserves the right to refuse to honor this warranty for any products improperly modified, installed, used, abused, or damaged including modifications to electrical specifications or other problems not due to defects in Roll Rite, LLC workmanship or materials.

Except as outlined below, this warranty is specifically limited to the replacement or repair, at Roll Rite, LLC's option, of any such warrantable defects or premature wear, without charge, when the complete product is returned to the factory freight prepaid.

**You must obtain a Return Goods Authorization (RGA) number before returning the product. To apply for a RGA number use our online [RGA form here](#) - or - contact the factory at 800-297-9905. Products received without a RGA number clearly marked on the outside of the package will be refused.**

Products that are returned for warranty examination and that are found to be non-warrantable are chargeable. Damaged non-warrantable products will only be returned to the customer if this is requested before any work is begun. The customer will be responsible for the cost of repair and return shipping of non-warrantable products. Payment authorization must be received by Roll-Rite, LLC before any non-warrantable equipment is returned. Warrantable products are repaired or replaced at no charge and returned freight prepaid via the same or comparable means that were used to send the product in.

This limited warranty excludes all other warranties, express or implied. Except as specifically outlined above, Roll-Rite, LLC shall not be liable for warranty in any amount exceeding the purchase price of the goods. Roll-Rite, LLC shall not be liable for any special incidental or consequential damages. This warranty gives you specific legal rights. You may also have other rights, which may vary from state to state and country to country.

For more information, please call the factory at **1-800-297-9905**. Outside U.S. & Canada: 989-345-3434 Fax: 989-345-7805 e-mail: [info@RollRite.com](mailto:info@RollRite.com)